



Clairemont Canyons Academy Elementary School

4133 Mt. Albertine Ave.
San Diego, CA 92111



Sub-district: A
Cluster: Madison
Year School Opened: 1961/1962
Grades: K-5



① Whole Site Modernization and Joint Use Field

This 7 acre campus is nestled in the community of Clairemont Mesa surrounded by the residential neighborhood. The approximate 98,000 square feet of facilities are two school sites joined by a common playground area. The diverse student population is on average 400 ranging from preschool to 5th grade. The school curriculum is aligned with the Service Learning Magnet program for all classes. With this program, students are taught servicing their community through various outreach projects throughout the school year.

The facilities make up several learning spaces for students that consist of administration offices, classrooms, library and media, multipurpose room with food services, and resource teaching rooms. There are seven permanent buildings that were built in 1961 and 1962, and 29 portable classroom buildings were added throughout the years due to increased student population. In 2004, a library building was constructed.



Clairemont Canyons Academy Whole Site Modernization and Joint Use Field with the City of San Diego



Estimated Construction Completion: Spring 2024

Funding: Propositions S and Z

The Whole Site Modernization project repairs, renovates, and revitalizes existing facilities at portions of the Clairemont Canyons Academy Elementary School campus. This may include building systems repair and replacement, accessibility and code compliance, and interior improvements at existing buildings. The project provides a new building with classrooms, instructional support, and administrative spaces. Improving student pick-up/drop-off zone and adding parking.

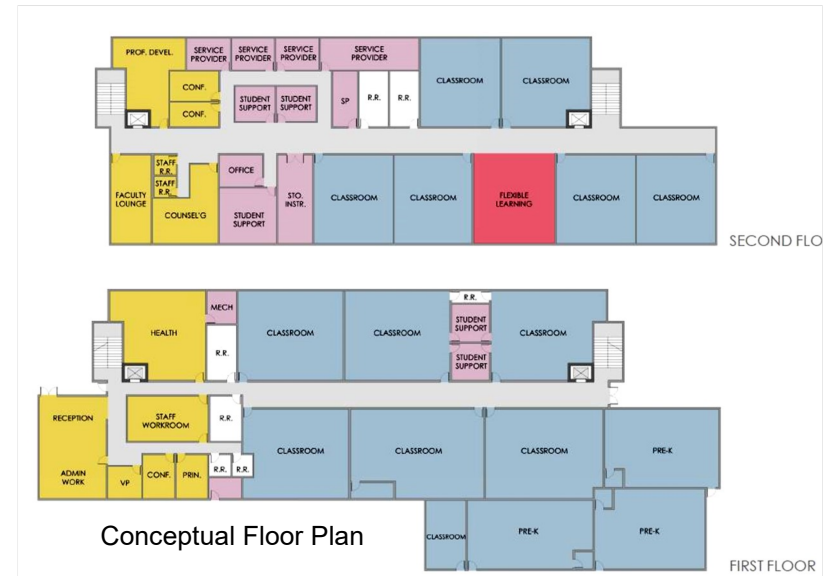

Clairemont Canyons Academy Elementary School

Whole Site Modernization and Joint Use Field with the City of San Diego

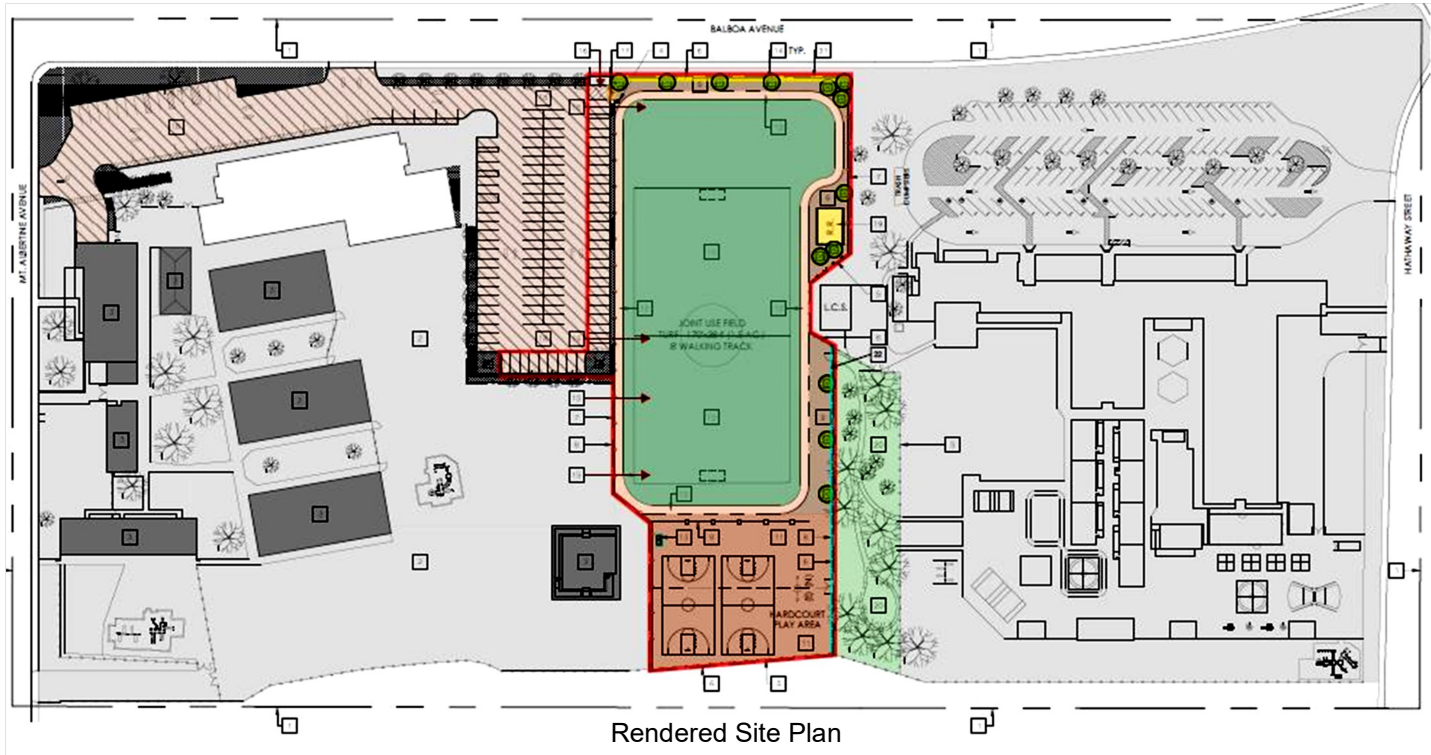

This project also includes a Joint Use Agreement project with the District and City of San Diego that involves the construction by the District on the schools existing Decomposed Granite (DG) Field. The agreement allows the Joint Use Field to be used by the students during school hours and open as a

public park to the community after school, on weekends and during school breaks.

Joint Use Area features:

- Natural Grass Field
- Walking/Jogging Track
- Basketball Courts

- Paved Parking Lot
- Accessible Route of Travel
- New Trees
- Security Fencing
- Accessible Drinking Fountain